



Red Oaks Mead, Epping, CM16

BUTLER  STAG



Red Oaks Mead is a beautifully presented four-bedroom family home set across three levels in the heart of desirable Theydon Bois. Tucked away in a quiet cul-de-sac, this property offers generous living space, two well-appointed bathrooms, a double garage, and landscaped gardens to both the front and rear.



Freehold

- Semi Detached Family Home
- Well Presented
- Front & Rear Garden
- Four Bedrooms/Two Bathrooms
- Double Garage/Off Street Parking
- Close To Theydon Bois Station

On the ground floor, a spacious entrance hall leads through to a bright, dual-aspect living room with charming character features, including wooden flooring, a cast iron fireplace, and French doors that open onto the rear garden. Opposite, the kitchen/diner overlooks the garden and features sleek white gloss cabinetry, black tiled splashbacks, striking worktops, and a butler sink that adds a touch of period charm. A modern family bathroom completes this level.

The first floor hosts the principal bedroom, a generous single bedroom, and a second family bathroom designed with stylish Victorian influences, including patterned floor tiles and a traditional-style basin. On the top floor are two further double bedrooms, each with skylight windows and built-in storage in the eaves, providing versatile spaces ideal for children, guests, or working from home.

The landscaped rear garden is ideal for entertaining, with a blend of patio, lawn, and decking areas surrounded by mature planting. The generous front garden provides further greenery and privacy, alongside driveway parking and a double garage.

Positioned within the leafy setting of Epping Forest, this is a rare opportunity to enjoy village life just a short stroll from Theydon Bois Underground Station. With local shops, pubs, restaurants and beautiful forest walks all within easy reach, this is a home that perfectly balances convenience and countryside living.





Red Oaks Mead

Approx. Gross Internal 160.6 Area Sq M (1728.6 Sq Ft)

BUTLER & STAG

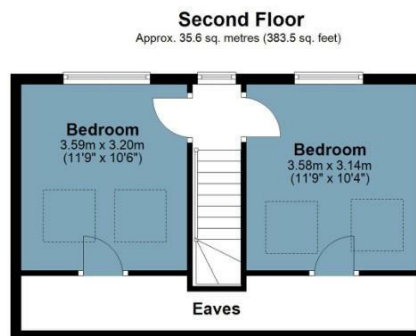
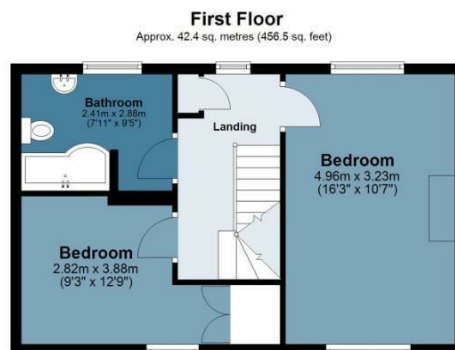

Measurements are approximate and for illustration purposes only. While we do not doubt the accuracy and completeness, we advise you conduct a careful independent assessment of the property to determine monetary value.
© @modephoto.uk www.modephoto.co.uk

BUTLER & STAG

☎ 01992 667666

🏠 4 Forest Drive, Theydon Bois, Essex, CM16 7EY

✉ theydon@butlerandstag.com

www.butlerandstag.uk

IMPORTANT NOTICE - These particulars have been prepared in good faith and they are not intended to constitute part of an offer or contract. We have not performed a structural survey on this property and the services, appliances and specific fittings have not been tested. All photographs, measurements, floor plans and distances referred to are given as a guide and should not be relied upon.